



2<sup>nd</sup> SpaceWire  
international conference  
in Nara

NOMACH, Masaharu

Osaka University



# Organization

## **Chairperson**

NOMACHI, Masaharu (Osaka University)

## **Co-chairpersons**

PARKES, Steve (University of Dundee)

TAKAHASHI, Tadayuki (JAXA)

## **Agency and Institution Representatives**

ESA                      Ph. Armbruster

JAXA/ISAS              T. Takahashi

NASA                     G. Rakow

ROSCOSMOS          A.G. Sukhoroukov



# Local organization

JAXA

Finance, Web site, Poster

Registration with JTB

Proceedings

OSAKA University

Conference site, Logistics

# Technical Committee (2007)

- Philippe Armbruster ESA, The Netherlands
- Glenn Rakow NASA GSFC, USA
- Martin Suess ESA, The Netherlands
- Steve Parkes University of Dundee, Scotland, UK
- Tadayuki Takahashi JAXA, Japan
- Yuriy Sheynin St. Petersburg State University of Aerospace Instrumentation, Russia
- Masaharu Nomachi University of Osaka, Japan
- Sandra Dykes Southwest Research Institute, USA
- Rick Schnurr NASA GSFC, USA
- Jim Lux NASA JPL, USA
- Kush Tyagi Los Alamos National Labs, USA
- Kerrin Rees MSSL, University College London, UK
- Stephane Davy ObsPM, France
- Manuel Prieto Alcala University, Spain
- Ben Greene Astrium Ltd, UK
- Bruno Masson Alcatel Alenia Space, France
- Giovanni Saldi Alcatel Alenia Space, Italy
- Olivier Notebaert Astrium SAS, France
- Paul Rastetter Astrium GmbH, Germany
- Torbjorn Hult Saab Space, Sweden
- Gerald Kempf Austrian Aerospace

**Can we keep the list?**

# Date and schedule

	Morning	Afternoon	Evening
3/November (Monday)	National holiday in Japan		
4/November (Tuesday)			Reception In the garden
5/November (Wednesday)			Banquet In the hotel
6/November (Thursday)			
7/November (Friday)	Interagency meeting		

# Season

- 4-6 November

## Average Number of Rainy Days

Years on Record: 30

YEAR	Jan.	Feb.	Mar.	Apr.	May	Jun.	Jul.	Aug.	Sep.	Oct.	Nov.	Dec.	
Days	93.2	6	7	7.3	8.3	8.5	11.1	10.6	7.1	10	6.6	4.3	6.4

## Average Number of Days Above 90F/32C

Years on Record: 10

YEAR	Jan.	Feb.	Mar.	Apr.	May	Jun.	Jul.	Aug.	Sep.	Oct.	Nov.	Dec.	
Days	12.9	---	---	---	---	---	0.1	3.5	8.5	0.8	---	---	---

## Average Number of Days Below 32F/0C

Years on Record: 10

YEAR	Jan.	Feb.	Mar.	Apr.	May	Jun.	Jul.	Aug.	Sep.	Oct.	Nov.	Dec.
Days	7.4	4.8	1.7	0.7	---	---	---	---	---	---	---	0.2

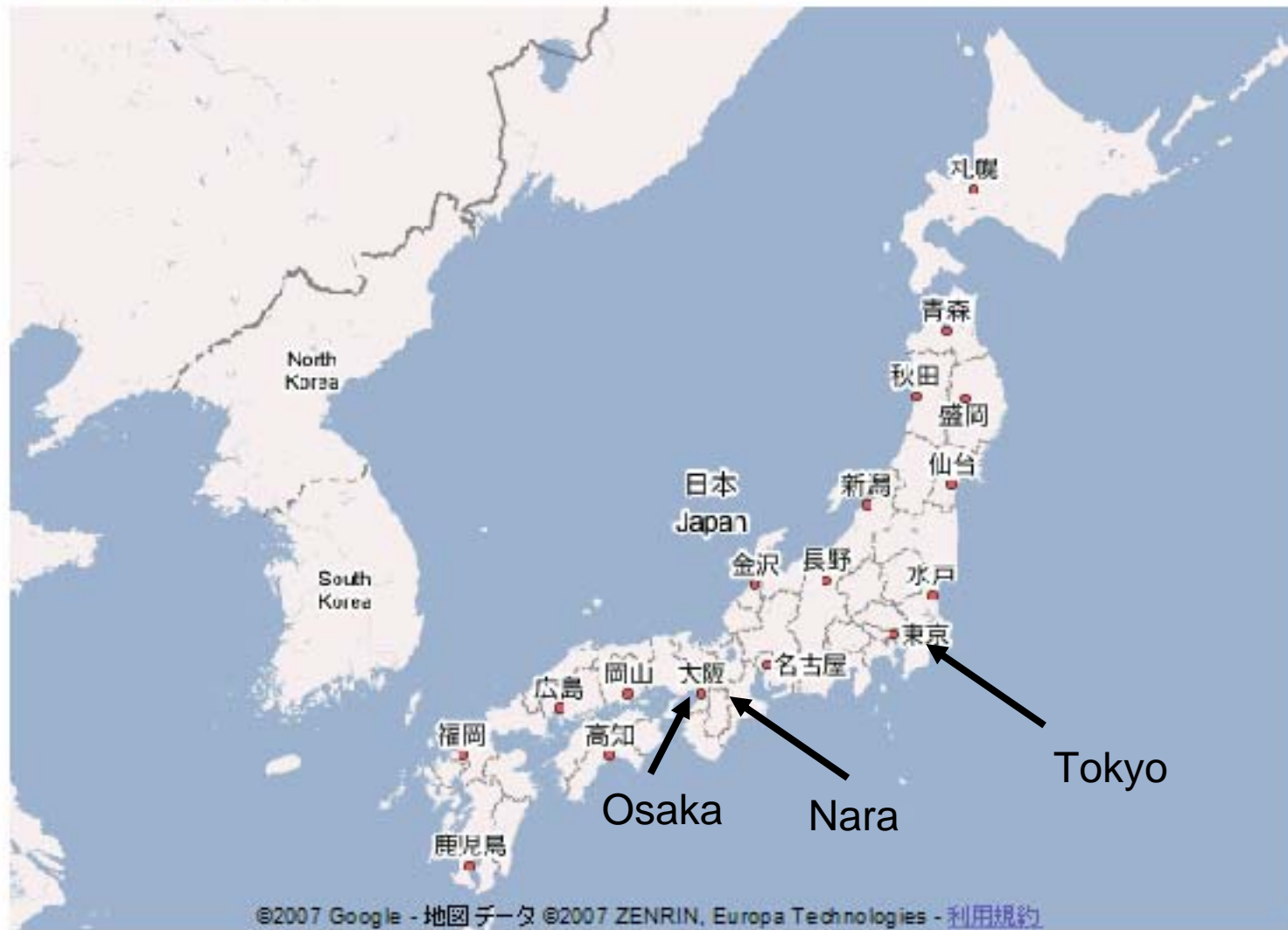





# Nara

Nara was the capital of Japan from 710 to 784

<http://www.kohfukuji.com/complex.htm>

<http://www.kcn.ne.jp/~info-ncb/e/ekaijyo2.html>





# Candidates for conference site

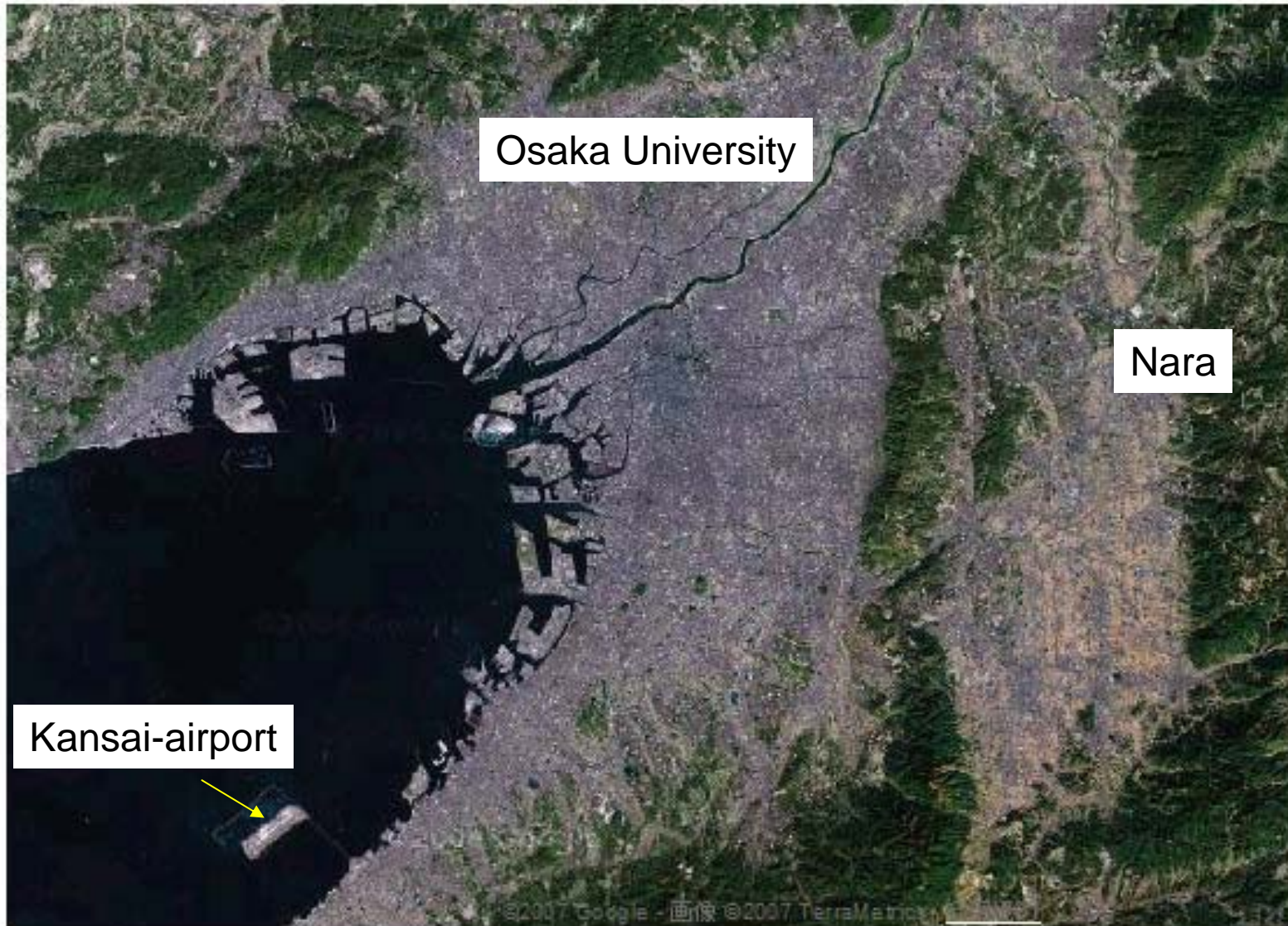

# 奈良県新公会堂

Nara Prefectural New Public Hall

Explanation from

<http://www.shinkokaido.jp/>



Nara-Ken New Public Hall was constructed in 1987 in commemoration of the 100th anniversary of the establishment of Nara Prefecture. It is located in the center of Nara National Park, which is famous for its beauty and 1,200 tame deer.

Nara was the capital of Japan from 710 to 784, so, it has many historical shrines and temples containing national treasures. Famous tourist spots such as Kofukuji Temple, Todaiji Temple, Kasuga Shrine are within walking distance from the hall.

The Hall has an impressive Noh theatre, which can be easily converted into a multi-purpose auditorium, conference rooms with simultaneous interpretation equipments for up to four languages, a reception hall and a spacious garden.



住所 奈良県新公会堂

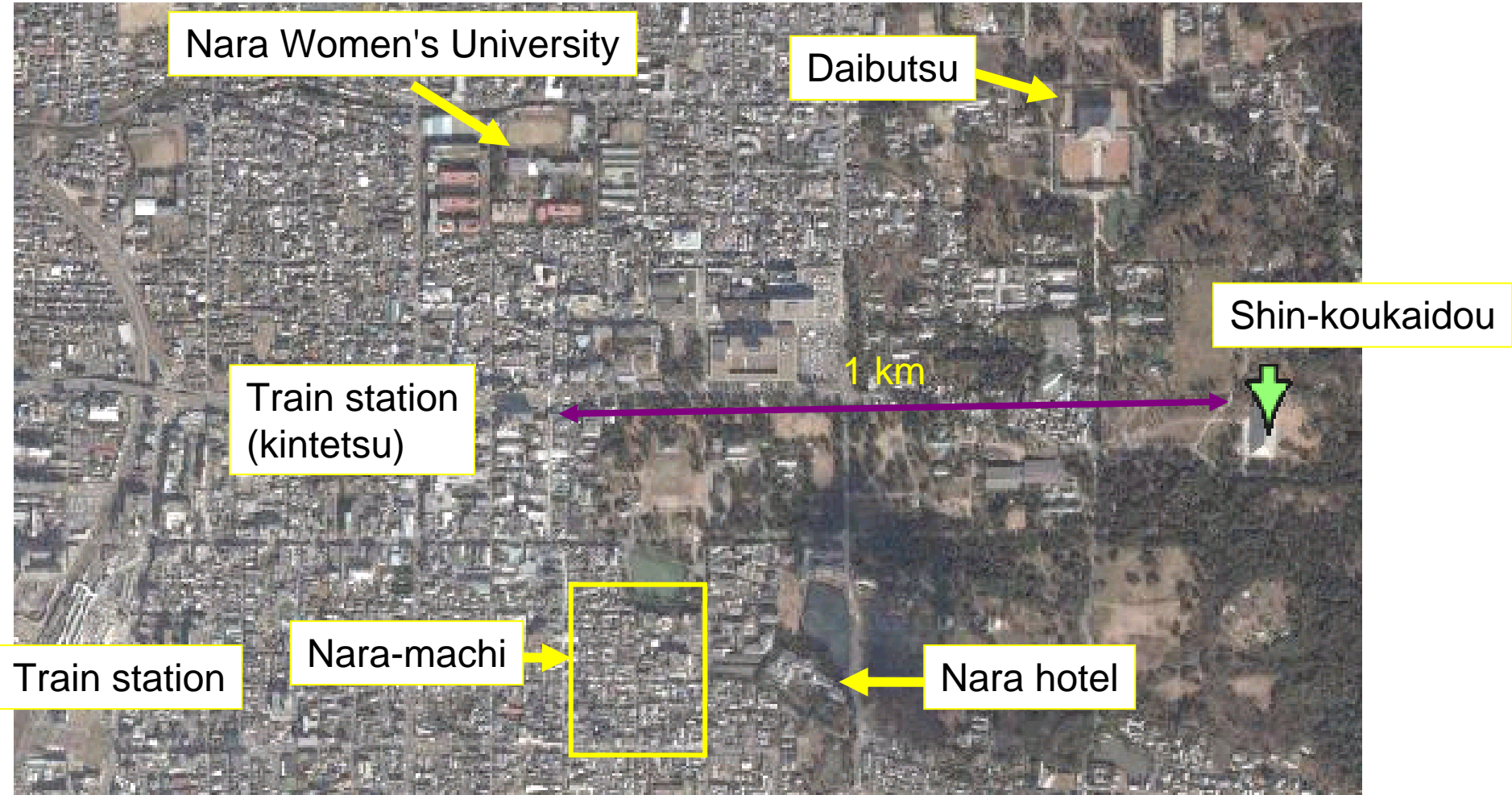



With a seating capacity of up to 500, the multi-purpose Noh theatre / auditorium provides an excellent facility for all types of performances, lectures, international meetings, and other events in addition to the traditional Japanese Noh drama. The theatre includes film projection equipment, a traditional Noh stage whose column can be removed for an unobstructed view of the stage, and simultaneous interpretation facilities.



Noh is a classical Japanese performance form which combines elements of dance, drama, music and poetry into one highly aesthetic stage art. Largely based in the cities of Tokyo, Osaka, and Kyoto, it is performed throughout the country by professional artists, mainly men, who have passed down the art among family members for numerous generations. There is also a wide following of both male and female amateurs who practice and perform its chant, dance, and instruments.

(from <http://www.ijnet.or.jp/NOH-KYOGEN/english/english.html>)





There is no paint on the wood. You will get good smell.

### Caution

You are not allowed to touch any wooden part on the stage.

You have to off your shoos to make presentation.

Presentation with KIMONO (traditional costume) is welcome.

■ 2nd Floor

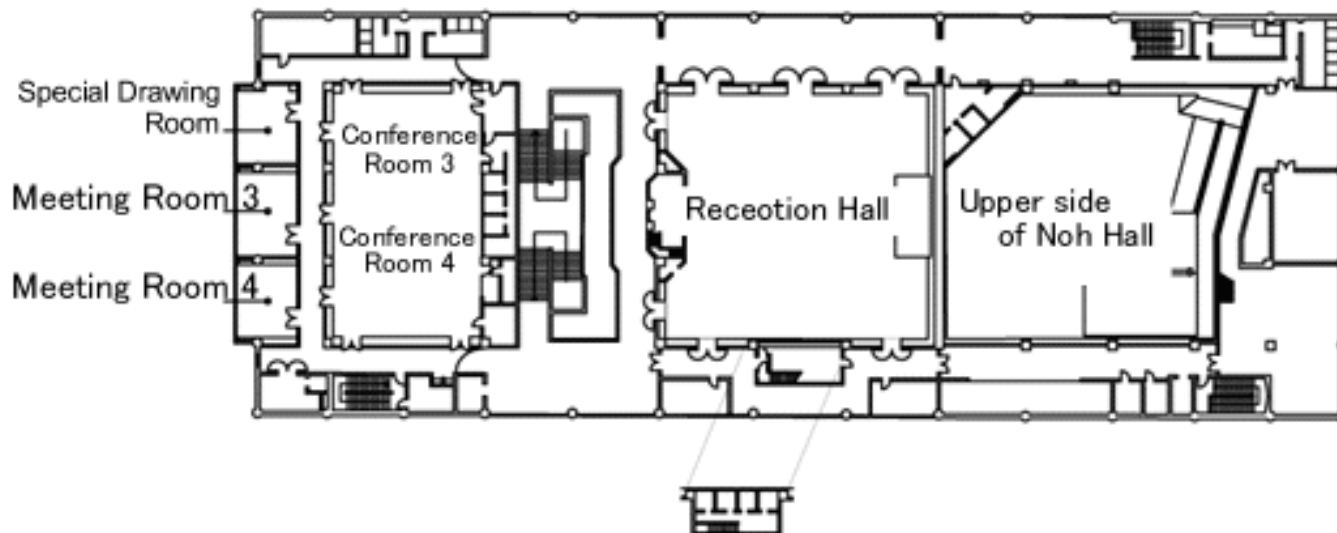

■ 1st Floor

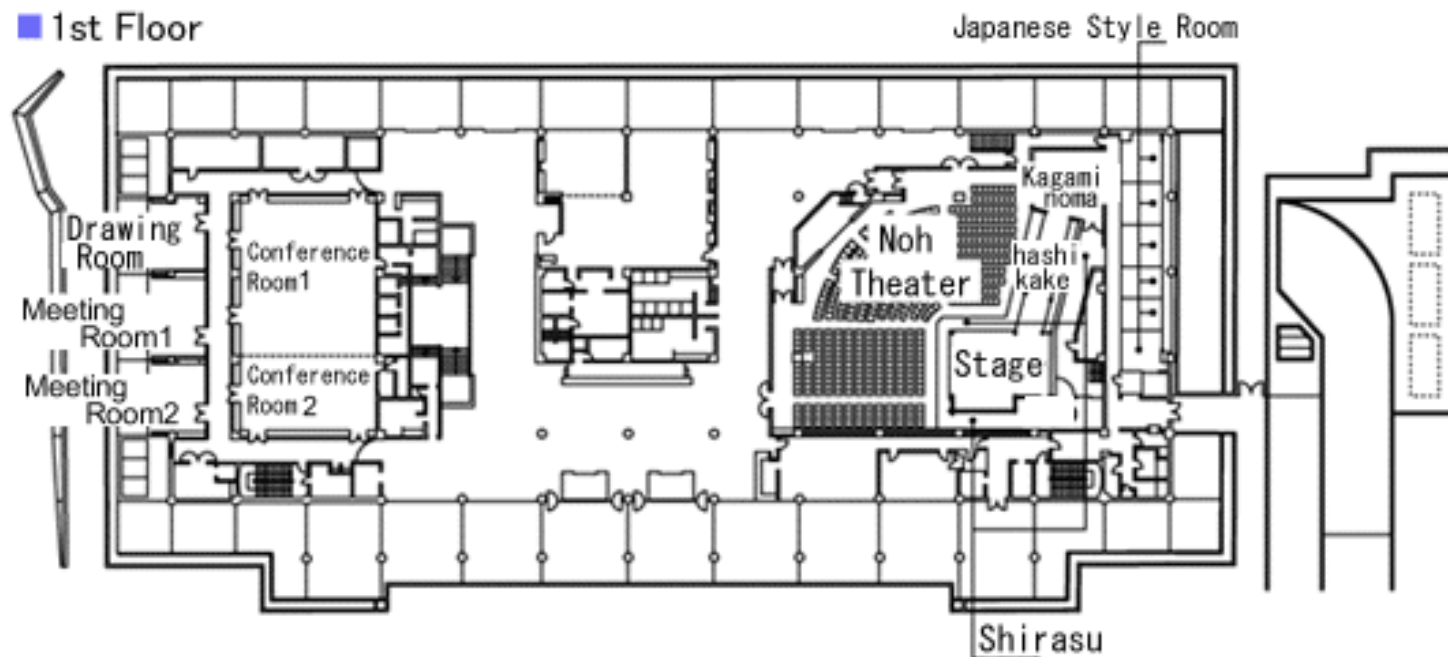

# Key Dates

	2007	2008
Abstract	8/Jun	early July
Paper acceptance notification	10/Jul	August (before or after summer vacation)
Early registration	30/Aug	Early October
Accommodation booking	30/Aug	<b>It is very busy season We recommend to book earlier</b>
Full paper submission	01/Sep	Mid October
Conference date	17-19/Sep	4-6/Nov

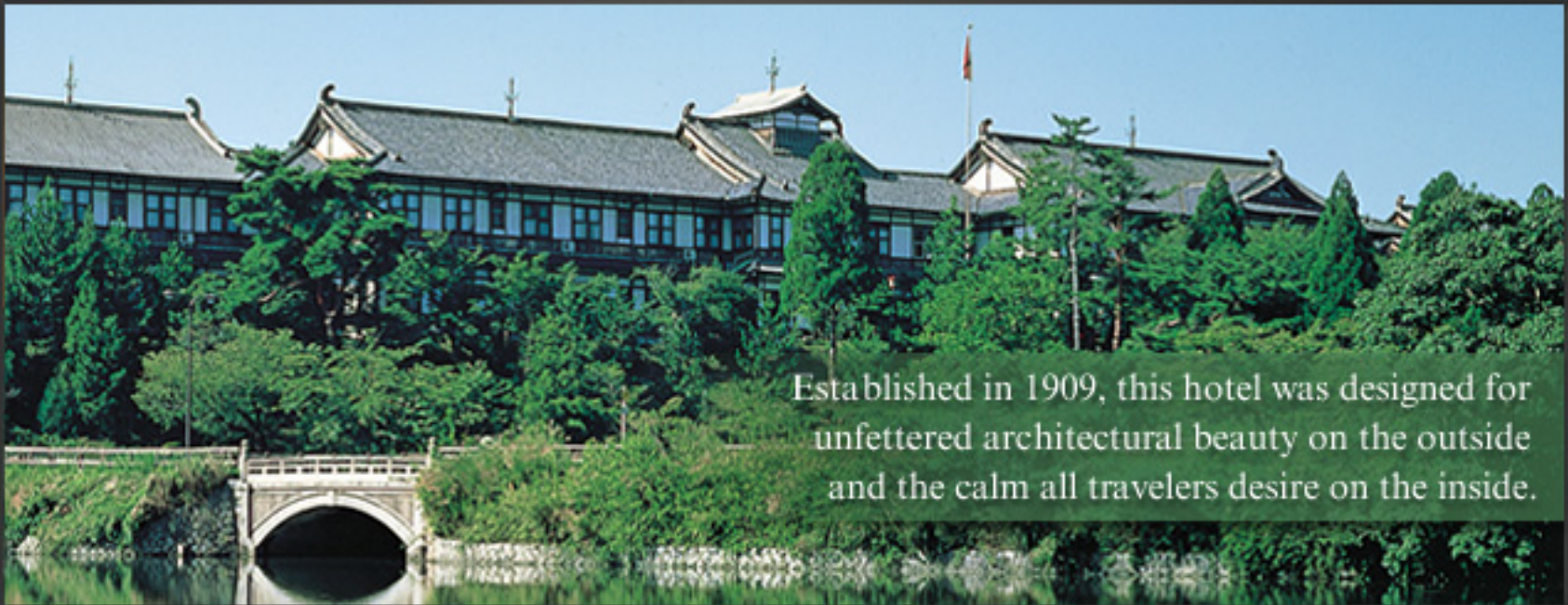

Established in 1909, this hotel was designed for unfettered architectural beauty on the outside and the calm all travelers desire on the inside.

## Nara Hotel

### Single Room

(1 person(s), Includes service-charge, tax, No meals/room charge) 14,000(JPY)

SpW WG 10, NOMACHI, M.



#### Hotel Fujita 1.3 km

115 rooms, 20 single 20 twin will be available for the conference

<http://www.fujita-nara.com/e/index.html>

9,200 yen + tax (single) 8,200 yen + tax (twin/person) with breakfast

#### Hotel Sun-route 1.1 km

95 rooms, 25~30 will be available for the conference

<http://www.sunroute-nara.co.jp/en/index.html>

7,300 yen ( can not confirmed. Group discount is available)

#### Hotel Nikko Nara

2.1km 330 rooms

<http://www.jalhotels.com/domestic/kansai/nara/index.html>

about 11,000 yen

#### Nara Washington hotel plaza

1.3km 204 rooms

in Japanese <http://nara.wh-at.com/>

7,000 yen ~ 10,000 yen

#### Hotel Asyl Nara

1.5km 42 rooms

in Japanese <http://worldheritage.co.jp/>

~ 7,000 yen

#### Super hotel Nara JR

2 km 70 rooms

Budget hotel 5,000 yen

If you are interested in Japanese style hotel, called ryokan, there are many in Nara.

In traditional Ryokan, minimum 2 person per room is required and dinner is included.

Price is 15,000~30,000 yen for each person.

There are another kind of ryokan. It is a sort of dormitory.

A group of students share a room for budget travel. It costs around 4,000 yen.

They often provide cheap rooms for foreign back-packers.



# Naramachi area

Nara is a small city. There are many restaurants in the downtown.

At the center (with in 500m from the station), there are 169 restaurants in the list of Yahoo.1000 -1500 yen for lunch, 1500-3000 yen for dinner.



# Local transportation

- To Kyoto 35min, to Osaka 36 min by express train.
- Hotels, restaurants, attractions, stations and the conference site are within a walking distance. (East-west 2km, North-South 1km.)
- TAXI 2km costs 880 yen.
- **There is BUS connection from Kansai International Airport.** The bus stops at Nara Hotel. 1,800 yen. About 80 min.
- Train takes 60 min for/from Kansai Airport. (No direct train)

# Nara National Museum

The Nara National Museum is located in a corner of Nara Park and surrounded by such ancient complexes as Tōdai-ji Temple, Kōfuku-ji Temple, and Kasuga Shrine. The museum, which celebrated its centennial anniversary in 1995, has long been deeply involved in the preservation, inventory, and research of Japanese antiquities and archeological artifacts, especially artworks related to Buddhism. Through the years, with the cooperation of temples, shrines, and private collectors, we have organized numerous exhibitions introducing a wealth of outstanding artworks associated with the Buddhist faith and the rich historical and cultural backgrounds in which they were produced. In April 2001, the Nara National Museum-together with the Tokyo and Kyoto National Museums-became semi-privatized, forming one branch of the newly established organization, National Museum. This administrative change should allow us to further enrich our activities and services in the future.

(message from [http://www.narahaku.go.jp/index\\_e.html](http://www.narahaku.go.jp/index_e.html))

# Lunches meals:

At Conference site, the capacity is 80 persons. The site is in the park. Nearest restaurant is 300m and most of restaurants are 0.8km-1.0 km. So, we should have longer lunch break or organize **lunch boxes**. A lunch box (Ben-toh) costs 500 yen to 2000 yen. Reasonable quality for the conference attendants is 1000-1500 yen. One example can be seen in

<http://www4.kcn.ne.jp/~taku3/newpage37.html> .

Reception hall is available for lunch. If weather is fine, we can have a lunch in the beautiful Japanese garden.



lunch box (1,000 yen)



SpW WG 10, NOMACHI, M.